



## 4 BED TRANSITIONAL HOUSE PLAN WITH VAULTED SPACES INDOORS AND OUT

- Main Level Primary Suite
- Vaulted Great Room & Primary
- 10' Ceilings on Remainder of Main Level
- 9' Ceilings on Upper Level
- 9' Ceilings in Lower Level

**THIS PLAN FITS ON LOT 1 + LOT 8**



5,778 SQ. FT.



6 BEDROOMS



6.5 BATHROOMS



3-CAR GARAGE

### MAIN LEVEL



### UPPER LEVEL



### LOWER LEVEL

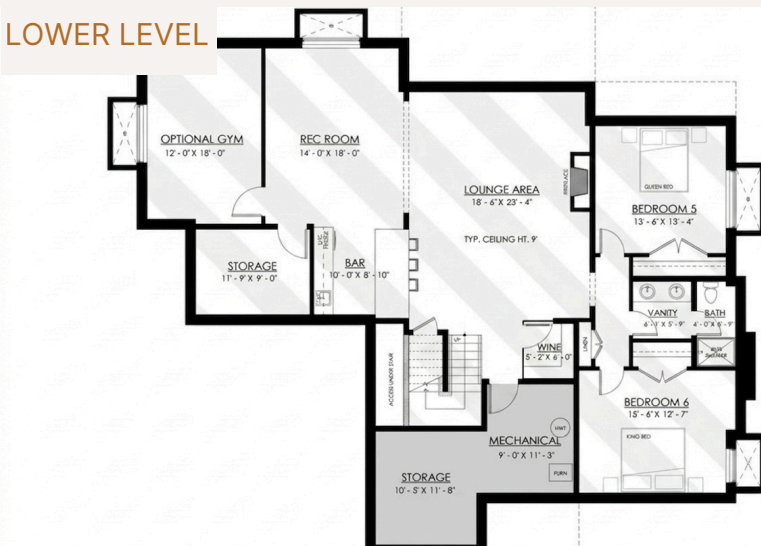

### PLAT MAP

